

# Garde Boue Arrière

Rear mudguard

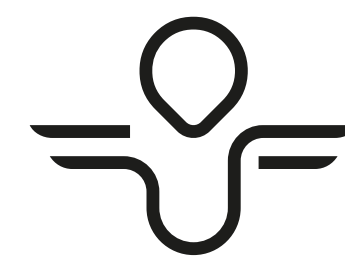

Notice de montage  
Assembly instructions

Compatibilité :  
Compatibility:

Angell /S



# Glossaire

## Glossary

Garde Boue Arrière  
Rear mudguard

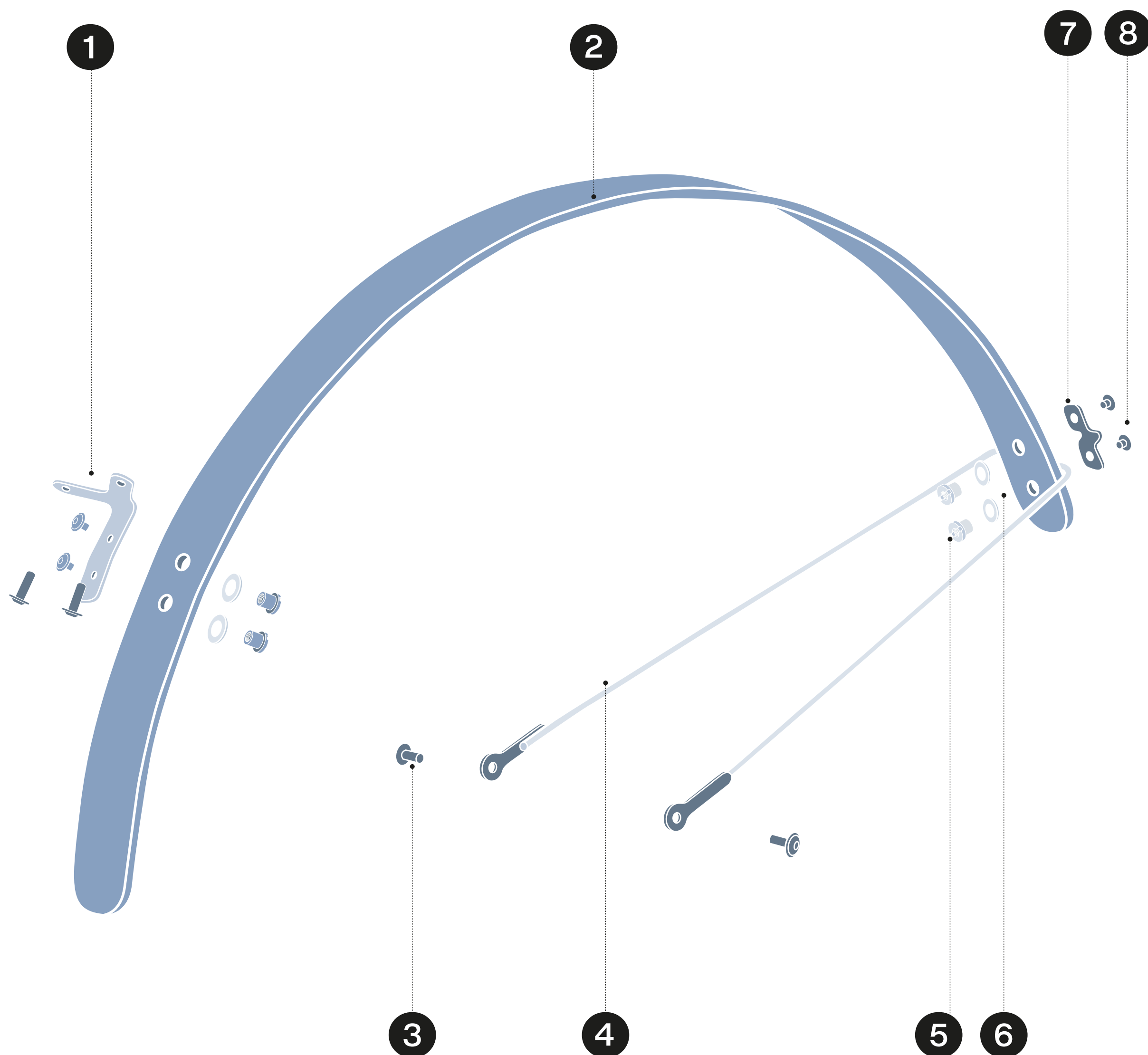

Réf.  
Réf.

Pièces détachées  
Component parts

8 Types  
8 Types

**1** x 1  
Support fixation haute  
Upper mounting bracket



**2** x 1  
Pièce en bois  
Wooden part



**3** x 4  
Vis TBHC M5x16  
M5x16 BHC screw



**4** x 1  
Tringle métallique  
Metallic rod

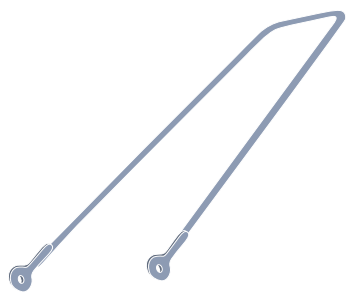

**5** x 2  
Écrous M5x6  
M5x6 nut



**6** x 4  
Rondelles M8x16  
M8x16 washers



**7** x 1  
Support fixation bas  
Lower mounting bracket



**8** x 4  
Vis TBHC M5x6  
M5x6 BHC screw



# Étapes

## Steps

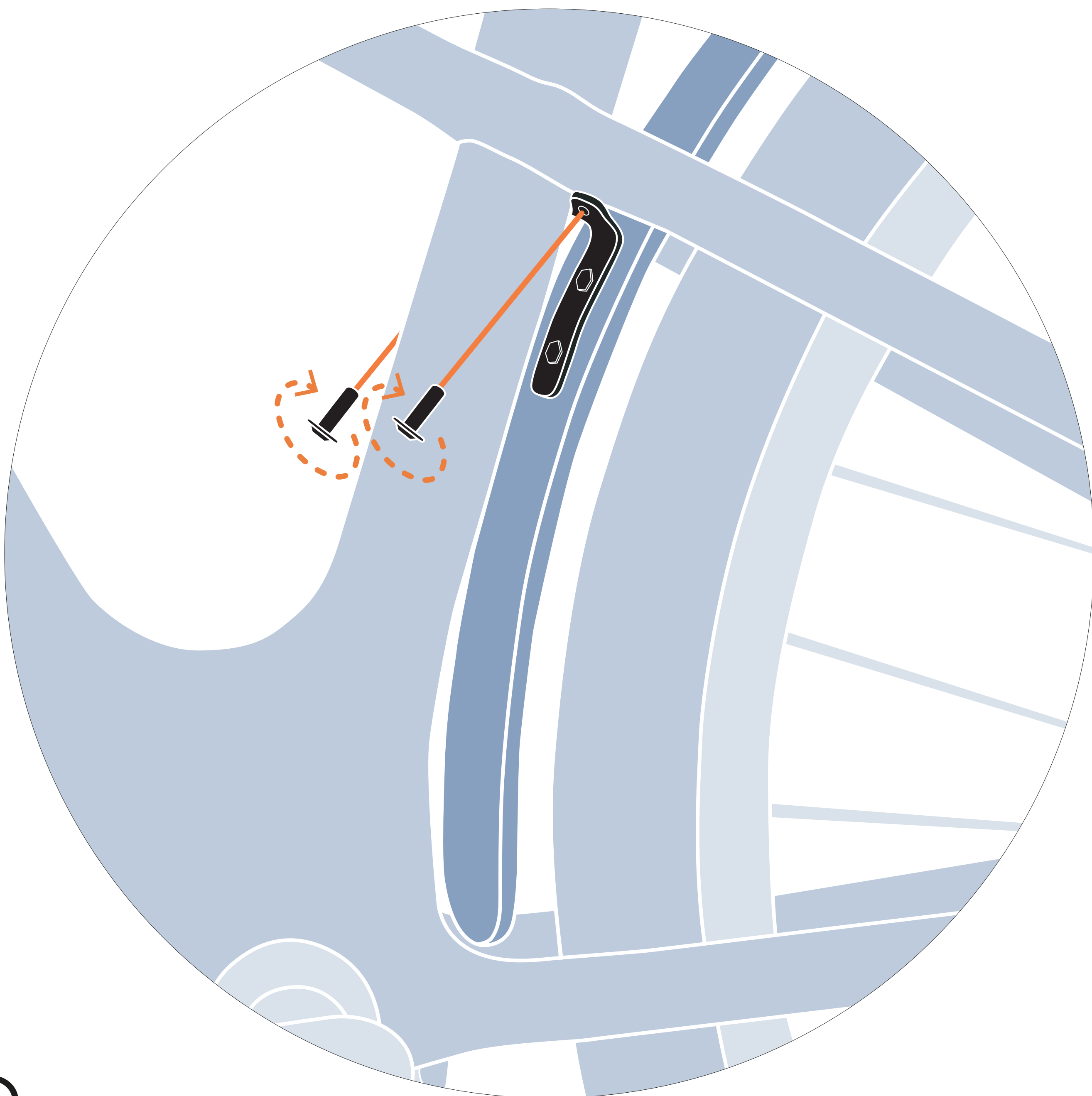

①

Visser les deux vis M5x16 au travers du support de fixation haut et des trous taraudés dans le cadre.

*Couple de serrage 2.2N.m ± 0.2*

Screw the two M5x16 screws through the top mounting bracket and the threaded holes in the frame.

*2.2N.m ± 0.2 tightening torque*

# Étapes

## Steps

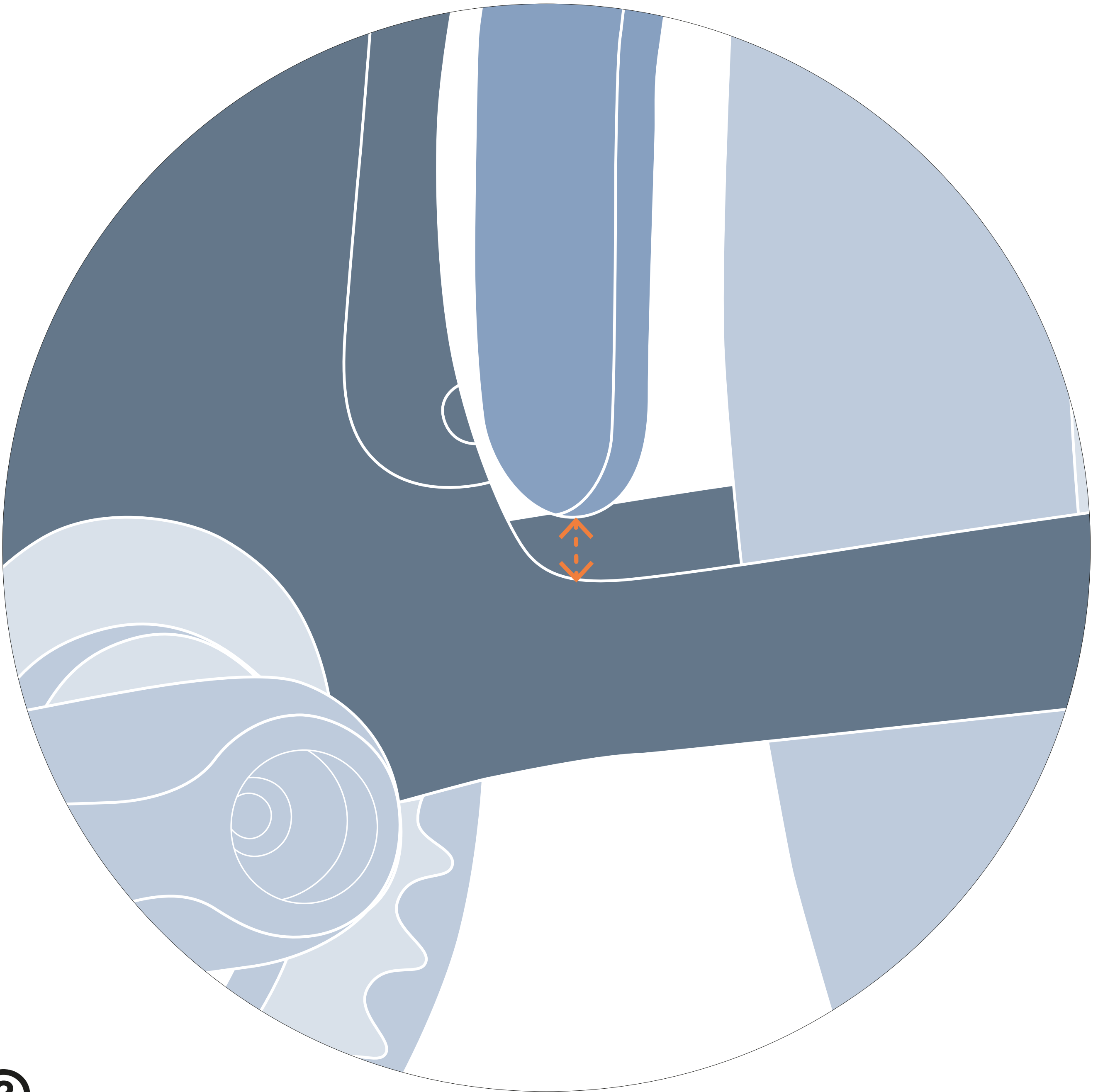

②

Assurez-vous que la partie bois inférieure ne soit pas en contact avec le cadre.

Check that the wooden part is not in contact with the bike frame.

# Étapes

## Steps

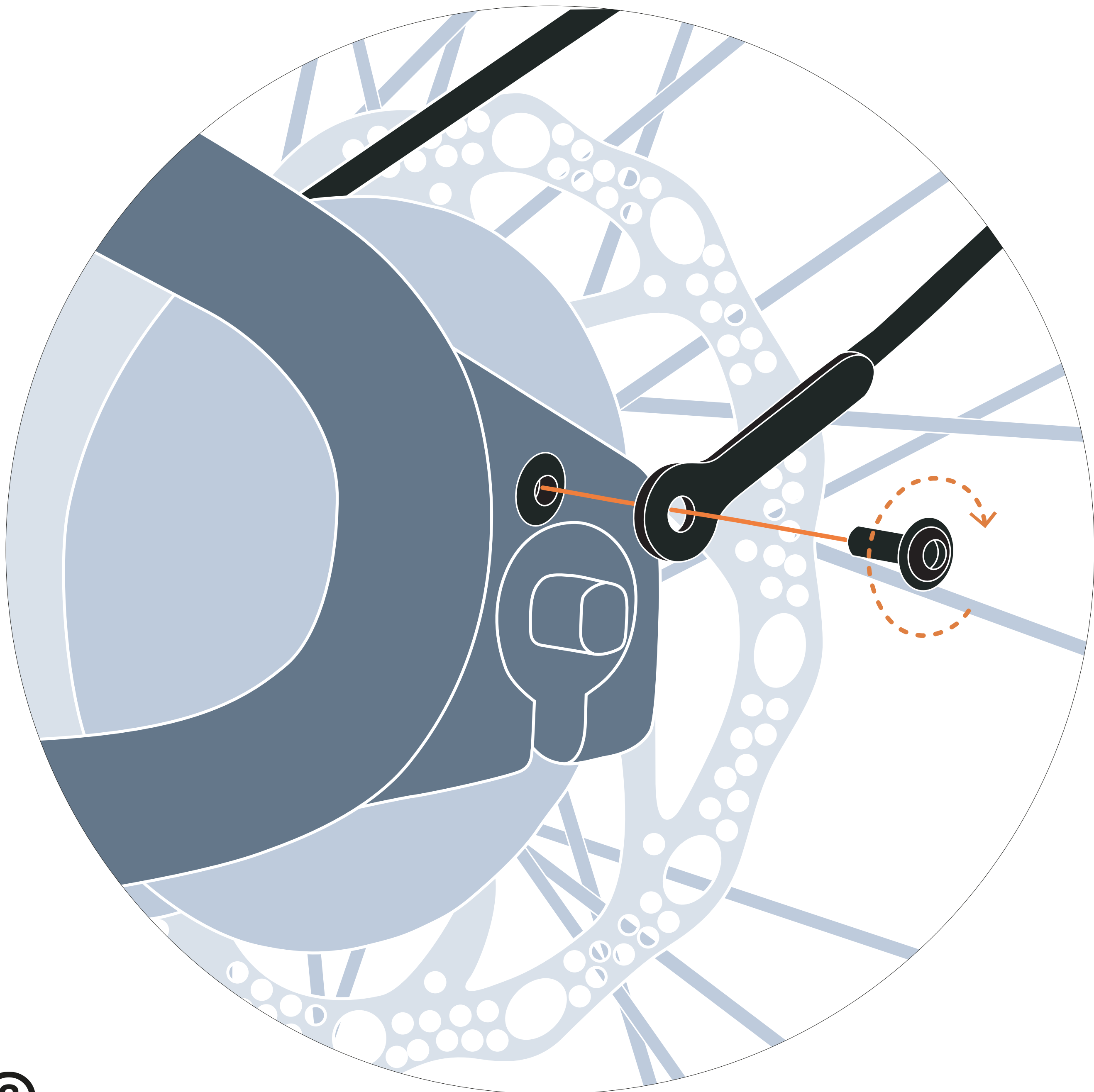

③

Visser les deux vis M5x16 au travers des platines de fixation des tringles et des trous taraudés dans le cadre.

*Couple de serrage 2.2N.m ± 0.2*

Bolt the two M5x16 screws through the rods mounting plates and the threaded holes in the bike frame.

*2.2N.m ± 0.2 tightening torque*